

W01

Cylindrical LPG for multivalves

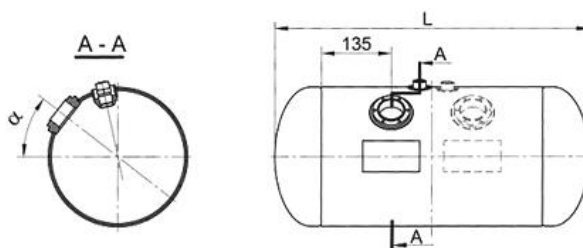

APPLICATION:

Liquid gas propane-butane mixture storage for admission of petrol engines in passenger cars, commercial and delivery vehicles.

STANDARD TANK:

1. Manufactured according to UN ECE 67R.01
2. Equipped with STAKO safety valve
3. Valve boss at the left, at 30°
4. Colour satin black RAL 9005

TECHNICAL DATA:

Class 1
 Design and test pressure: 3000 kPa
 Working pressure: max. 2000 kPa

OPTIONS:

1. Valve boss at the right, at 0° or 90°
2. Orientation cross
3. Different colour

NOTES:

1. Valve boss positioning – solid line shows valve boss at the left (X), Broken line shows valve boss at the right (Y).

HOW TO ORDER:

W Diameter Capacity Version

np. W20001001

DIMENSIONS:

Part number	Diameter D [mm]	Capacity V [l]	Mass [kg]	Length L [mm]
W20001001	200	10	6,4	382
W20001501	200	15	8,6	550
W20002001	200	20	10,8	717
W20002501	200	25	13	884
W20003001	200	30	15,1	1052
W20003501	200	35	17,3	1219
W20004001	200	40	19,5	1387

STAKO sp.j.
 Poznańska 54
 76-200 Słupsk
 Poland

tel.: +48 59 8424895
 fax: +48 59 8481999

stako@stako.pl
 www.stako.pl



W20004501	200	45	21,6	1554
W23002301	230	23	11,2	630
W23003001	230	30	13,8	809
W23003801	230	38	16,9	1014
W23004701	230	47	20,3	1245
W24402401	244	24	12	600
W24403601	244	36	16,2	860
W24404201	244	42	18,4	1000
W24405201	244	52	21,6	1200
W27002501	270	25	13,4	514
W27003001	270	30	15,4	607
W27003501	270	35	17,3	699
W27004001	270	40	19,2	792
W27004501	270	45	21,2	884
W27005001	270	50	23,1	977
W27005501	270	55	25	1069
W30004001	300	40	17,6	646
W30004501	300	45	19,3	720
W30005001	300	50	21	793
W30005501	300	55	22,7	867
W30006001	300	60	24,4	940
W30006501	300	65	26,2	1014
W30007001	300	70	27,9	1088
W31503501	315	35	15,9	531
W31504001	315	40	17,6	599
W31504501	315	45	19,3	667
W31505001	315	50	20,9	734
W31505501	315	55	22,5	802
W31506001	315	60	24,2	869
W31506501	315	65	25,8	937
W31507001	315	70	27,5	1004
W31508001	315	80	30,8	1139
W31509001	315	90	34	1274
W31510001	315	100	37,3	1409
W31511001	315	110	40,6	1544
W36004001	360	40	17	478
W36005001	360	50	19,9	582
W36005501	360	55	21,3	632
W36006001	360	60	22,8	686

STAKO sp.j.
Poznańska 54
76-200 Słupsk
Poland

tel.: +48 59 8424895
fax: +48 59 8481999

stako@stako.pl
www.stako.pl



W36007001	360	70	25,7	789
W36008001	360	80	28,5	892
W36008501	360	85	30	944
W36009001	360	90	31,4	996
W36010001	360	100	34,3	1099
W36010501	360	105	36	1160
W36011001	360	110	37,2	1203
W36011601	360	116	39	1265
W36012001	360	120	40,1	1307
W36013001	360	130	43	1411
W36014001	360	140	46	1515
W40009001	400	90	30,2	847
W40010001	400	100	32,8	930
W40011001	400	110	35,4	1014
W40012001	400	120	38	1097
W40013001	400	130	40,6	1180
W40014001	400	140	43,1	1263
W40015001	400	150	45,7	1347
W40016001	400	160	48,3	1430
W40017001	400	170	50,9	1514
W40018001	400	180	53,5	1597
W40019001	400	190	56,1	1680
W40020001	400	200	58,7	1764
W45012001	450	120	34,5	861
W45014001	450	140	39	990
W45016001	450	160	43,6	1119
W45018001	450	180	48,1	1248
W45020001	450	200	52,6	1378
W45023001	450	230	59,4	1571

STAKO sp.j.
Poznańska 54
76-200 Słupsk
Poland

tel.: +48 59 8424895
fax: +48 59 8481999

stako@stako.pl
www.stako.pl

